

PIPERA - Cozy semi-detached 5 bedrooms villa in residential compound
1st rental

2,200 € / lună



GENERAL INFORMATION

- 6 rooms
- level: P+1E+M
- construction year: 2024

AREAS

- built: 211.2 sqm
- usable: 155 sqm

CONTAINS

- 5 bedrooms
- 4 bathrooms

Utilities

air conditioning, stove, shower, bathtub, fridge, kitchen hood, washing machine, dishwasher, staircase, fully furnished, partially furnished, central heating, underfloor heating, closed kitchen, water meters, electricity meter, gas meter, private garden

Property details

Located in Pipera area, near the park and with easy access to the A3 highway, this compound is composed of 17 duplex villas and townhouse on a street with a roundabout and barrier. This duplex villa is developed on 3 levels GF+1+At, has a total area of 211sqm and 55sqm garden. The ground floor consists of living room with dining area and exit to the terrace, separate kitchen and guest toilet. Upstairs is the master bedroom with en-suite bathroom and 2 secondary bedrooms that share the 2nd bathroom. The attic consists of 2 bedrooms that share 1 bathroom. The villas benefit from architecture with French style influences, regardless of whether the villas are duplex or rows, they will have their own structure and exterior wall, brick walls, boiler and underfloor heating boiler, Salamander Bluevolution Class A joinery and pre-equipment kit for photovoltaic panels and connection for future electric car charging system.

<https://www.goldenkey.ro/en/property-cozy-semi-detached-5-bedrooms-villa-in-residential-compound-1st-rental-cp2183543>

ACCES

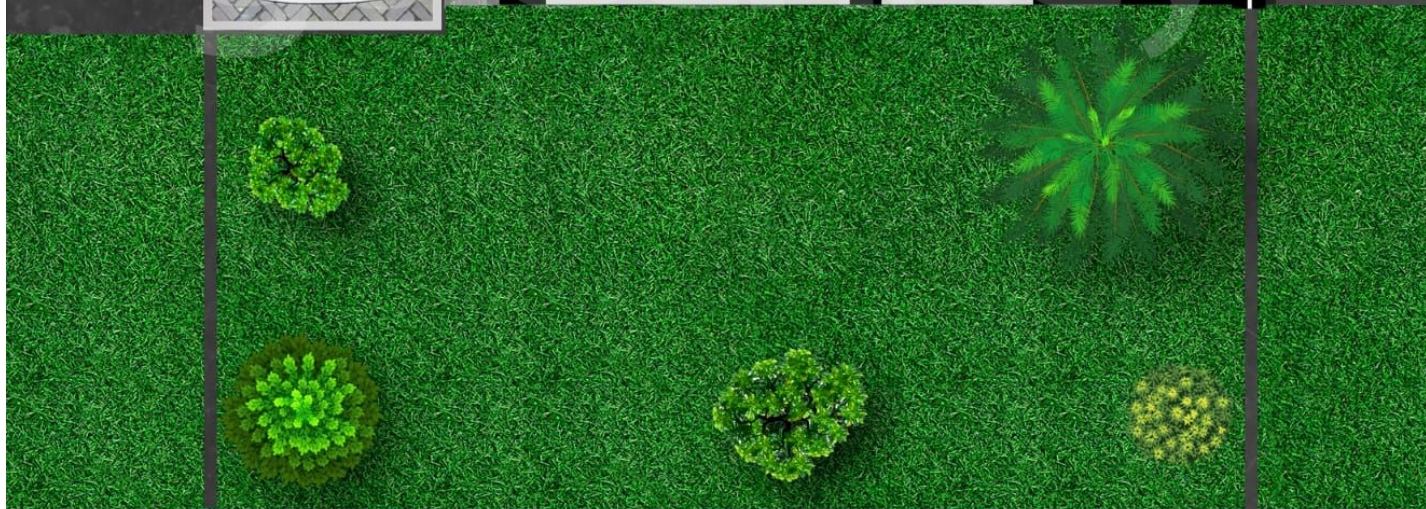
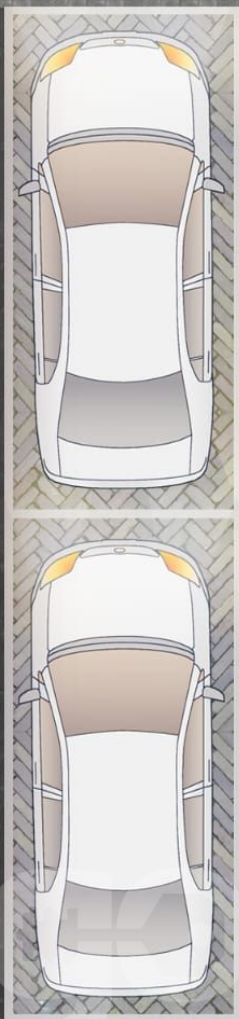

PLAN PARTER



C3-U5:

S. PARTER = 69.05mp
S. ETAJ 1 = 79.55mp
S. MANSARDA = 56.85mp
S. BALCOANE = 2.65mp
S. PODEST ACCES = 3.10mp

S. TOTAL CONSTRUIT =
211.20mp

S. CURTE = 54.90mp

Planurile prezentate au rol strict informativ.
Proiectul se execută pe baza planșelor tehnice și de specialitate.
Pot apărea modificări sau diferențe față de conținutul imaginilor de prezentare.

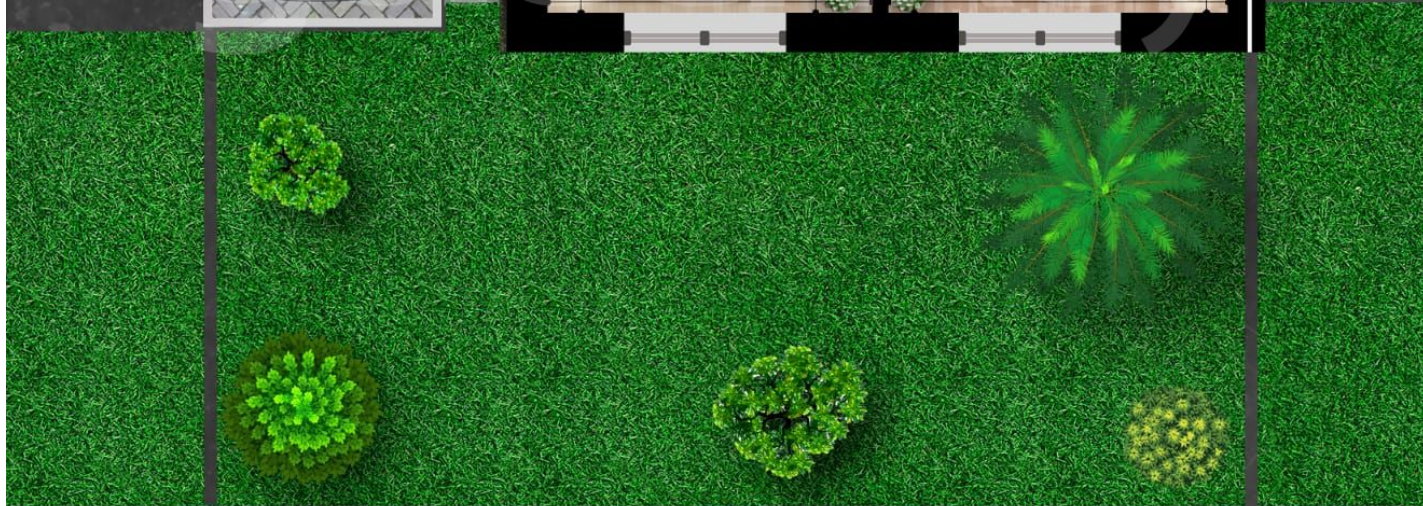
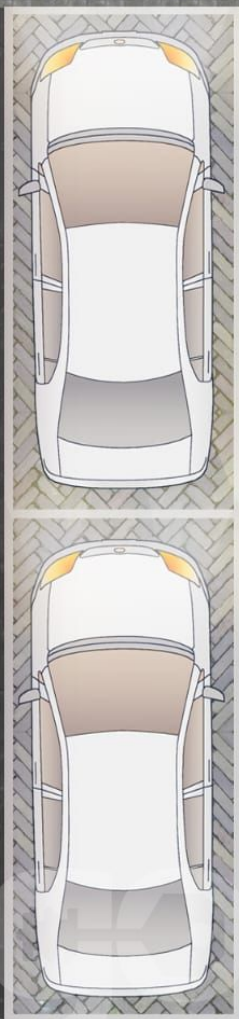

PLAN ETAJ 1



C3-U5:

S. PARTER = 69.05mp
S. ETAJ 1 = 79.55mp
S. MANSARDA = 56.85mp
S. BALCOANE = 2.65mp
S. PODEST ACCES = 3.10mp

S. TOTAL CONSTRUIT = 211.20mp

S. CURTE = 54.90mp

Planurile prezentate au rol strict informativ.
 Proiectul se execută pe baza planșelor tehnice și de specialitate.
 Pot apărea modificări sau diferențe față de conținutul imaginilor de prezentare.

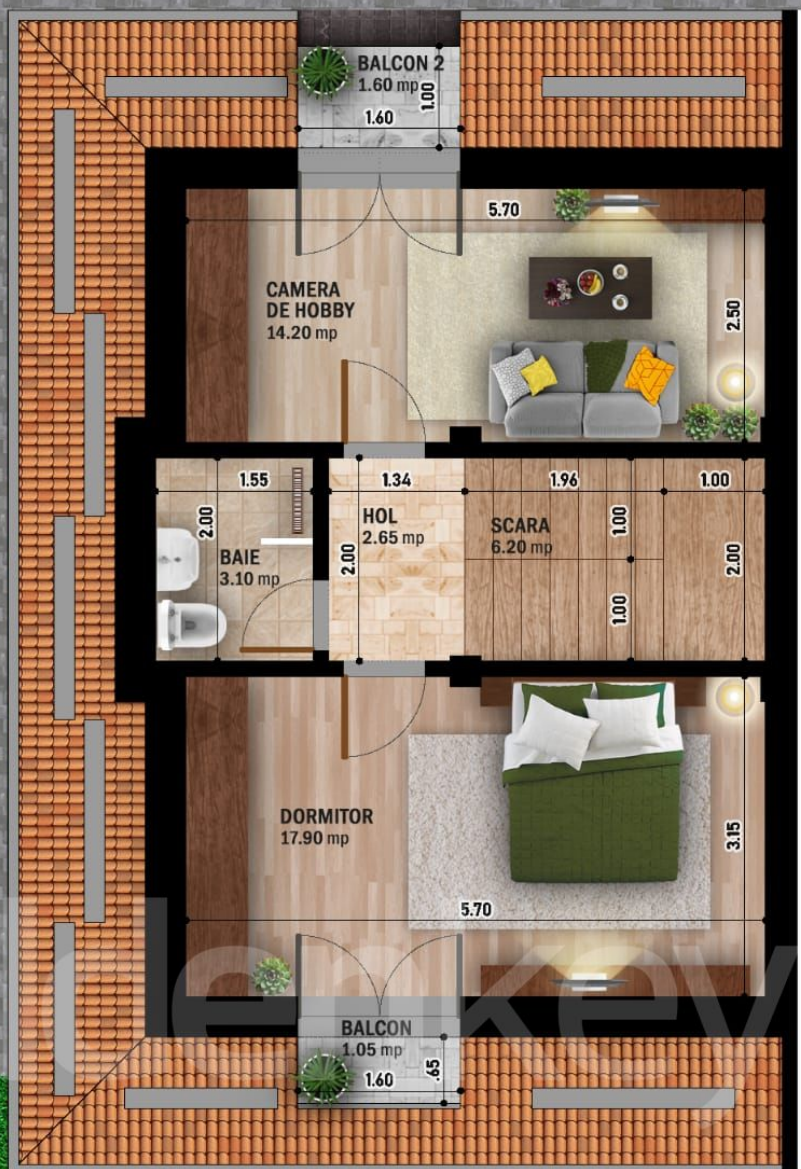
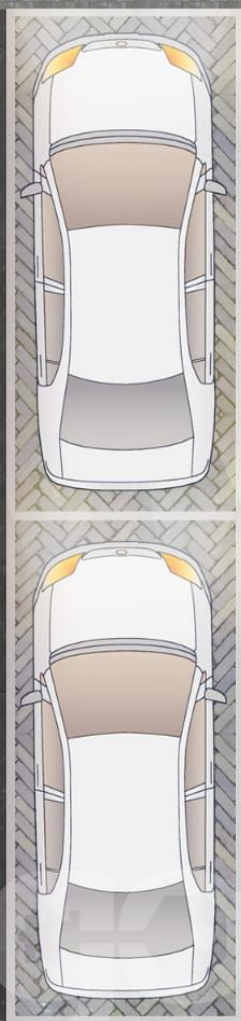

MANSARDA - SUGESTIE DE AMENAJARE



C3-U5:

S. PARTER = 69.05mp
S. ETAJ 1 = 79.55mp
S. MANSARDA = 56.85mp
S. BALCOANE = 2.65mp
S. PODEST ACCES = 3.10mp

S. TOTAL CONSTRUIT = 211.20mp

S. CURTE = 54.90mp

Planurile prezentate au rol strict informativ.
 Proiectul se execută pe baza planșelor tehnice și de specialitate.
 Pot apărea modificări sau diferențe față de conținutul imaginilor de prezentare.